

GRAND CANYON DRIVE

MINERAL POINT ROAD

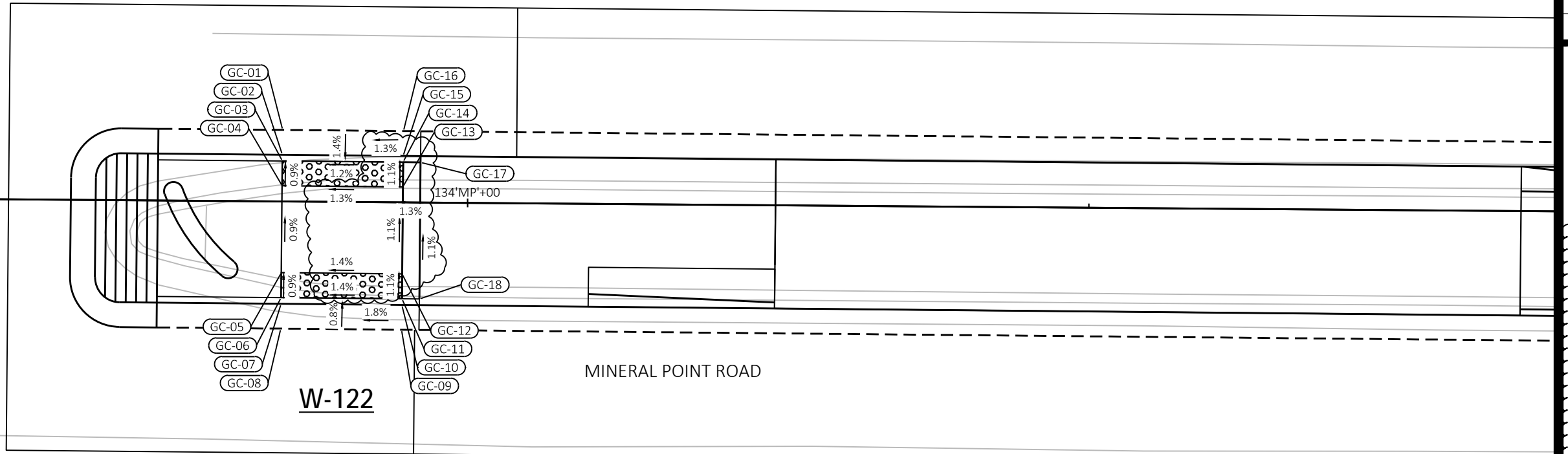

Grand Canyon						
POINT NUMBER	STATION	OFFSET	Y COORDS	X COORDS	ELEVATION	COMMENT
GC-01	133+85.07'Mineral'	5.77' LT	477761.40	791036.77	1042.99	FLANGE
GC-02	133+85.07'Mineral'	3.77' LT	477759.40	791036.79	1042.98	FLOW LINE
GC-03	133+85.07'Mineral'	3.27' LT	477758.90	791036.79	1042.99	BOC
GC-04	133+85.06'Mineral'	1.27' LT	477756.91	791036.81	1043.01	BOW
GC-05	133+85.05'Mineral'	5.73' RT	477749.91	791036.89	1043.07	BOW
GC-06	133+85.05'Mineral'	7.74' RT	477747.90	791036.91	1043.09	BOC
GC-07	133+85.05'Mineral'	8.23' RT	477747.41	791036.91	1043.09	FLOW LINE
GC-08	133+85.04'Mineral'	10.23' RT	477745.41	791036.94	1043.10	FLANGE
GC-09	133+94.77'Mineral'	10.25' RT	477745.51	791046.66	1043.27	FLANGE
GC-10	133+94.77'Mineral'	8.25' RT	477747.51	791046.64	1043.24	FLOW LINE
GC-11	133+94.77'Mineral'	7.75' RT	477748.01	791046.63	1043.23	BOC
GC-12	133+94.77'Mineral'	5.75' RT	477750.01	791046.61	1043.21	BOW
GC-13	133+94.79'Mineral'	1.25' LT	477757.01	791046.54	1043.13	BOW
GC-14	133+94.79'Mineral'	3.25' LT	477759.01	791046.52	1043.11	BOC
GC-15	133+94.79'Mineral'	3.75' LT	477759.51	791046.51	1043.10	FLOW LINE
GC-16	133+94.80'Mineral'	5.75' LT	477761.51	791046.49	1043.14	FLANGE
GC-17	133+96.19'Mineral'	3.25' LT	477759.02	791047.91	1043.13	EOW
GC-18	133+96.18'Mineral'	7.76' RT	477748.01	791048.04	1043.25	EOW

REVISED 4/5/23 ZTM

MARK	60631225P
DESIGNED BY: AECOM	DATE: 2023-04-07
REVISION	PLAN REVISION 2
ZTM	4/5/23
BY	

60631225P  
 CITY OF MADISON, DANE COUNTY, WI  
 CONTRACT NO: 60631225C

CURB RAMP DETAILS: MINERAL POINT ROAD AT GRAND CANYON DRIVE

BUS RAPID TRANSIT  
 CITY OF MADISON



60631225P  
 CR16-W

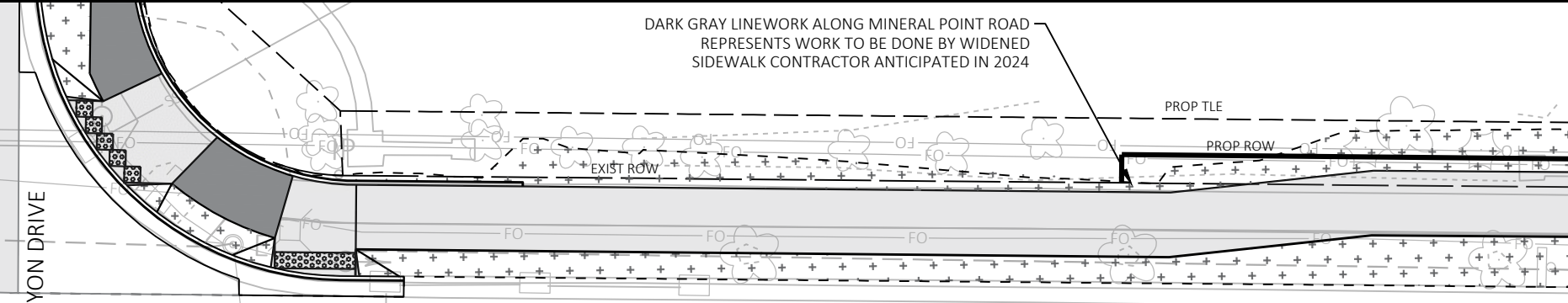

Mineral Point Road at Grand Canyon Drive						
POINT NUMBER	STATION	OFFSET	Y COORDS	X COORDS	ELEVATION	COMMENT
MPGC50	133+72.07	5.79' LT	477761.27	791023.77	1042.57	FLANGE
MPGC51	133+72.09	15.79' LT	477771.27	791023.66	1042.66	MATCH
MPGC52	134+24.79	3.80' LT	477759.93	791076.51	1043.99	FLOW LINE
MPGC53	134+84.79	3.69' LT	477760.56	791136.51	1045.81	FLOW LINE
MPGC54	134+84.77	8.51' RT	477748.36	791136.63	1045.99	FLOW LINE
MPGC55	134+24.77	8.40' RT	477747.73	791076.64	1044.17	FLOW LINE

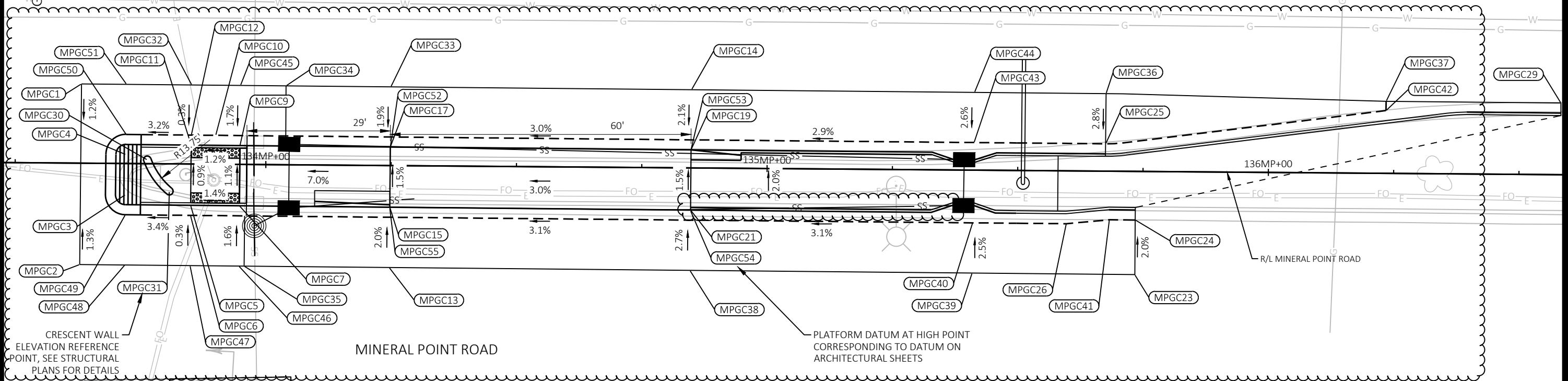
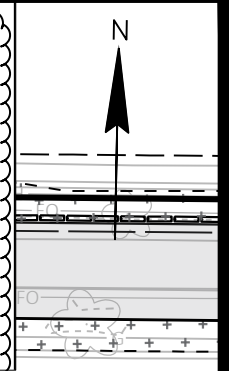

Mineral Point Road at Grand Canyon Drive						
POINT NUMBER	STATION	OFFSET	Y COORDS	X COORDS	ELEVATION	COMMENT
MPGC1	133+63.08	15.80' LT	477771.17	791014.66	1042.42	MATCH
MPGC2	133+63.02	20.20' RT	477735.17	791015.04	1042.50	MATCH
MPGC3	133+72.05	6.21' RT	477749.27	791023.89	1042.80*	CENTER
MPGC4	133+72.06	1.79' LT	477757.27	791023.81	1042.74*	CENTER
MPGC5	133+85.05	8.23' RT	477747.41	791036.91	1043.09	FLOW LINE
MPGC6	133+85.04	10.23' RT	477745.41	791036.94	1043.10	FLANGE
MPGC7	133+94.77	8.25' RT	477747.51	791046.64	1043.24	FLOW LINE
MPGC9	133+94.79	3.75' LT	477759.51	791046.51	1043.10	FLOW LINE
MPGC10	133+89.93	5.76' LT	477761.46	791041.63	1043.06*	CENTER
MPGC11	133+85.07	3.77' LT	477759.40	791036.79	1042.98	FLOW LINE
MPGC12	133+85.07	5.77' LT	477761.40	791036.77	1042.99	FLANGE
MPGC13	134+24.75	20.30' RT	477735.83	791076.76	1044.41	MATCH
MPGC14	134+84.81	15.59' LT	477772.46	791136.38	1046.06	MATCH
MPGC15	134+24.77	8.30' RT	477747.83	791076.64	1045.30	TOP

Mineral Point Road at Grand Canyon Drive						
POINT NUMBER	STATION	OFFSET	Y COORDS	X COORDS	ELEVATION	COMMENT
MPGC17	134+24.79	3.70' LT	477759.83	791076.51	1045.12	TOP
MPGC19	134+84.79	3.59' LT	477760.46	791136.51	1046.94	TOP
MPGC21	134+84.77	8.41' RT	477748.46	791136.63	1047.12	TOP
MPGC23	135+73.50	20.56' RT	477737.40	791225.50	1048.94	MATCH
MPGC24	135+73.47	9.69' RT	477748.27	791225.34	1048.72	MATCH
MPGC25	135+67.49	5.45' LT	477763.34	791219.17	1048.21	FLANGE
MPGC26	135+59.77	10.54' RT	477747.26	791211.65	1048.34	FLANGE
MPGC29	136+58.25	14.28' LT	477773.29	791309.82	1050.86	MATCH
MPGC30	133+76.32	0.76' LT	477756.29	791028.08	1043.22*	CENTER
MPGC31	133+80.76	5.47' RT	477750.11	791032.59	1043.42*	CENTER
MPGC32	133+85.09	15.77' LT	477771.40	791036.66	1043.02	MATCH
MPGC33	134+24.81	15.70' LT	477771.82	791076.38	1044.22	MATCH
MPGC34	134+03.91	15.73' LT	477771.60	791055.48	1043.59	MATCH
MPGC35	133+95.80	20.25' RT	477735.52	791047.82	1043.47	MATCH

Mineral Point Road at Grand Canyon Drive						
POINT NUMBER	STATION	OFFSET	Y COORDS	X COORDS	ELEVATION	COMMENT
MPGC36	135+67.50	15.45' LT	477773.33	791219.06	1048.49	MATCH
MPGC37	136+23.38	14.35' LT	477772.93	791274.95	1049.99	MATCH
MPGC38	134+84.75	20.41' RT	477736.46	791136.76	1046.31	MATCH
MPGC39	135+41.04	20.51' RT	477737.06	791193.05	1048.01	MATCH
MPGC40	135+41.06	10.51' RT	477747.06	791192.94	1047.76	FLANGE
MPGC41	135+68.36	9.69' RT	477748.20	791220.23	1048.58	FLANGE
MPGC42	136+23.37	12.50' LT	477771.07	791274.97	1049.92	FLANGE
MPGC43	135+41.24	5.49' LT	477763.06	791192.93	1047.46	FLANGE
MPGC44	135+41.26	15.49' LT	477773.06	791192.82	1047.72	MATCH
MPGC45	133+94.81	15.75' LT	477771.51	791046.38	1043.31	MATCH
MPGC46	133+94.75	20.25' RT	477735.51	791046.77	1043.43	MATCH
MPGC47	133+85.03	20.23' RT	477735.41	791037.04	1043.13	MATCH
MPGC48	133+72.03	20.21' RT	477735.27	791024.04	1042.75	MATCH
MPGC49	133+72.04	10.21' RT	477745.27	791023.94	1042.66	FLANGE

\* POINTS USED FOR CENTER MAY HAVE ZERO OR APPROXIMATED ELEVATIONS - THESE POINTS ARE INCLUDED IN THE TABLE FOR HORIZONTAL LOCATION. THE VERTICAL ELEVATION OF THESE POINTS ARE NOT INTENDED FOR CONSTRUCTION.

**60631225P**  
 GRADING PLAN: EBWB MINERAL POINT ROAD AT GRAND CANYON DRIVE  
 CITY OF MADISON, DANE COUNTY, WI  
**BUS RAPID TRANSIT**  
**CITY OF MADISON**  
 CONTRACT NO: 60631225C

PLAN REVISION 2  
 4/5/2023 ZTM  
 REVISION DATE BY  
 2023-04-07  
 Designed By: AECOM Date: 2023-04-07  
 60631225P  
 Scale: 1 IN=20 FT

FILE NAME: C:\P\WORKING\AECOM\_DS20\_NA\_2019\ANDREW.TIMCO@AECOM.COM\DM586348\050205C-GD.DWG  
 LAYOUT NAME - Plan 1 IN 20 FT  
 LAST PLOT DATE - 2023-04-07

Mineral Point Road at Island Drive						
POINT NUMBER	STATION	OFFSET	Y COORDS	X COORDS	ELEVATION	COMMENT
MPID39	159+64.49	12.02' LT	477786.30	793616.11	1009.93	FLANGE
MPID40	160+24.51	21.34' LT	477795.96	793676.08	1010.45	MATCH
MPID41	160+24.48	9.94' LT	477784.56	793676.11	1010.24	FLOW LINE
MPID42	160+84.51	21.15' LT	477796.12	793736.08	1010.75	MATCH
MPID43	161+36.49	11.49' LT	477786.76	793788.11	1010.90	MATCH
MPID44	161+36.44	4.51' RT	477770.76	793788.15	1010.73	MATCH
MPID45	160+84.41	14.35' RT	477760.62	793736.17	1010.60	MATCH
MPID46	160+84.44	2.45' RT	477772.52	793736.14	1010.43	FLOW LINE
MPID47	160+24.41	14.16' RT	477760.46	793676.17	1010.26	MATCH
MPID48	159+28.99	1.97' RT	477772.11	793580.69	1009.62	FLOW LINE
MPID49	158+73.08	12.70' RT	477761.06	793524.85	1009.48	TOP

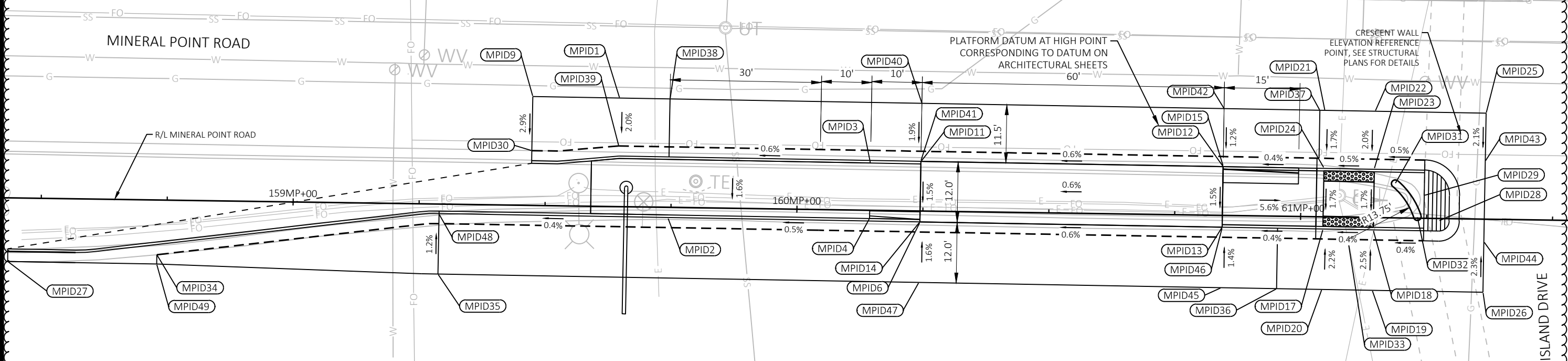
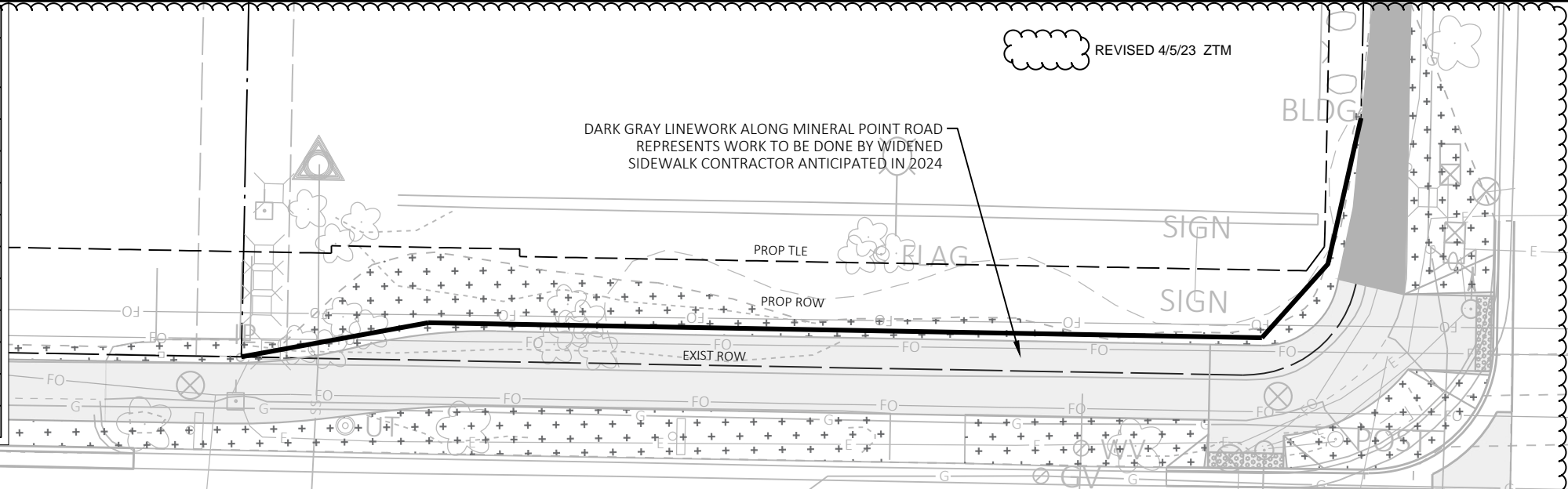

Mineral Point Road at Island Drive						
POINT NUMBER	STATION	OFFSET	Y COORDS	X COORDS	ELEVATION	COMMENT
MPID1	159+64.51	21.52' LT	477795.80	793616.08	1010.11	MATCH
MPID2	159+74.44	2.11' RT	477772.23	793626.14	1009.80	FLOW LINE
MPID3	160+14.48	9.30' LT	477783.86	793666.11	1010.67	TOP
MPID4	160+14.44	1.63' RT	477772.93	793666.14	1010.49	TOP
MPID6	160+24.44	2.26' RT	477772.36	793676.14	1010.06	FLOW LINE
MPID9	159+47.27	21.57' LT	477795.76	793598.84	1010.02	MATCH
MPID11	160+24.48	9.84' LT	477784.46	793676.11	1011.37	TOP
MPID12	160+84.48	9.65' LT	477784.62	793736.11	1011.74	TOP
MPID13	160+84.44	2.35' RT	477772.62	793736.14	1011.56	TOP
MPID14	160+24.44	2.16' RT	477772.46	793676.14	1011.19	TOP
MPID15	160+84.48	9.75' LT	477784.72	793736.11	1010.61	FLOW LINE

Mineral Point Road at Island Drive						
POINT NUMBER	STATION	OFFSET	Y COORDS	X COORDS	ELEVATION	COMMENT
MPID17	161+04.44	2.51' RT	477772.57	793756.14	1010.51	FLOW LINE
MPID18	161+14.44	2.54' RT	477772.60	793766.14	1010.55	FLOW LINE
MPID19	161+14.40	14.44' RT	477760.70	793766.17	1010.84	MATCH
MPID20	161+04.41	14.41' RT	477760.67	793756.17	1010.77	MATCH
MPID21	161+04.51	21.09' LT	477796.17	793756.08	1010.90	MATCH
MPID22	161+14.51	21.06' LT	477796.20	793766.08	1010.97	MATCH
MPID23	161+14.48	9.66' LT	477784.80	793766.11	1010.75	FLOW LINE
MPID24	161+04.48	9.69' LT	477784.77	793756.11	1010.70	FLOW LINE
MPID25	161+36.51	20.99' LT	477796.26	793788.08	1011.10	MATCH
MPID26	161+36.41	14.51' RT	477760.76	793788.17	1010.96	MATCH
MPID27	158+43.51	12.61' RT	477760.98	793495.27	1009.23	MATCH

Mineral Point Road at Island Drive						
POINT NUMBER	STATION	OFFSET	Y COORDS	X COORDS	ELEVATION	COMMENT
MPID28	161+27.45	0.48' RT	477774.73	793779.14	1010.86	CENTER
MPID29	161+24.46	4.53' LT	477779.72	793776.12	1011.24	CENTER
MPID30	159+47.23	10.85' LT	477785.04	793598.86	1009.71*	MATCH
MPID31	161+18.66	6.76' LT	477781.92	793770.31	1011.24*	CENTER
MPID32	161+23.15	0.29' LT	477775.48	793774.83	1011.14	CENTER
MPID33	161+09.44	4.42' RT	477770.68	793761.15	1010.58	CENTER
MPID34	158+73.09	10.85' RT	477762.92	793524.84	1009.42	MATCH
MPID35	159+28.96	13.87' RT	477760.21	793580.72	1009.77*	MATCH
MPID36	160+95.43	14.38' RT	477760.65	793747.19	1010.69	MATCH
MPID37	161+03.51	21.09' LT	477796.17	793755.08	1010.89	MATCH
MPID38	159+74.51	21.49' LT	477795.83	793626.08	1010.17	MATCH

\*POINTS USED FOR CENTER MAY HAVE ZERO OR APPROXIMATED ELEVATIONS - THESE POINTS ARE INCLUDED IN THE TABLE FOR HORIZONTAL LOCATION. THE VERTICAL ELEVATION OF THESE POINTS ARE NOT INTENDED FOR CONSTRUCTION

PLAN REVISION 2  
 4/5/2023 ZTM  
 DATE BY  
 REVISION  
 2023-04-07  
 MARK  
 Designed By: AECOM  
 Date: 2023-04-07  
 Scale: 1 IN:20 FT  
 60631225P

60631225P  
 CITY OF MADISON, DANE COUNTY, WI  
 CONTRACT NO: 60631225C

GRADING PLAN: MINERAL POINT ROAD AT ISLAND DRIVE  
 BUS RAPID TRANSIT  
 CITY OF MADISON

60631225P  
 G-6W

FILE NAME: C:\P\WORKING\AECOM\_D520\_NA\_2019\AN\DRAW:TIMCO@AECOM.COM\DM586348\050206C-GD.DWG  
 LAYOUT NAME - Plan 1 IN 20 FT  
 LAST PLOT DATE - 2023-04-07

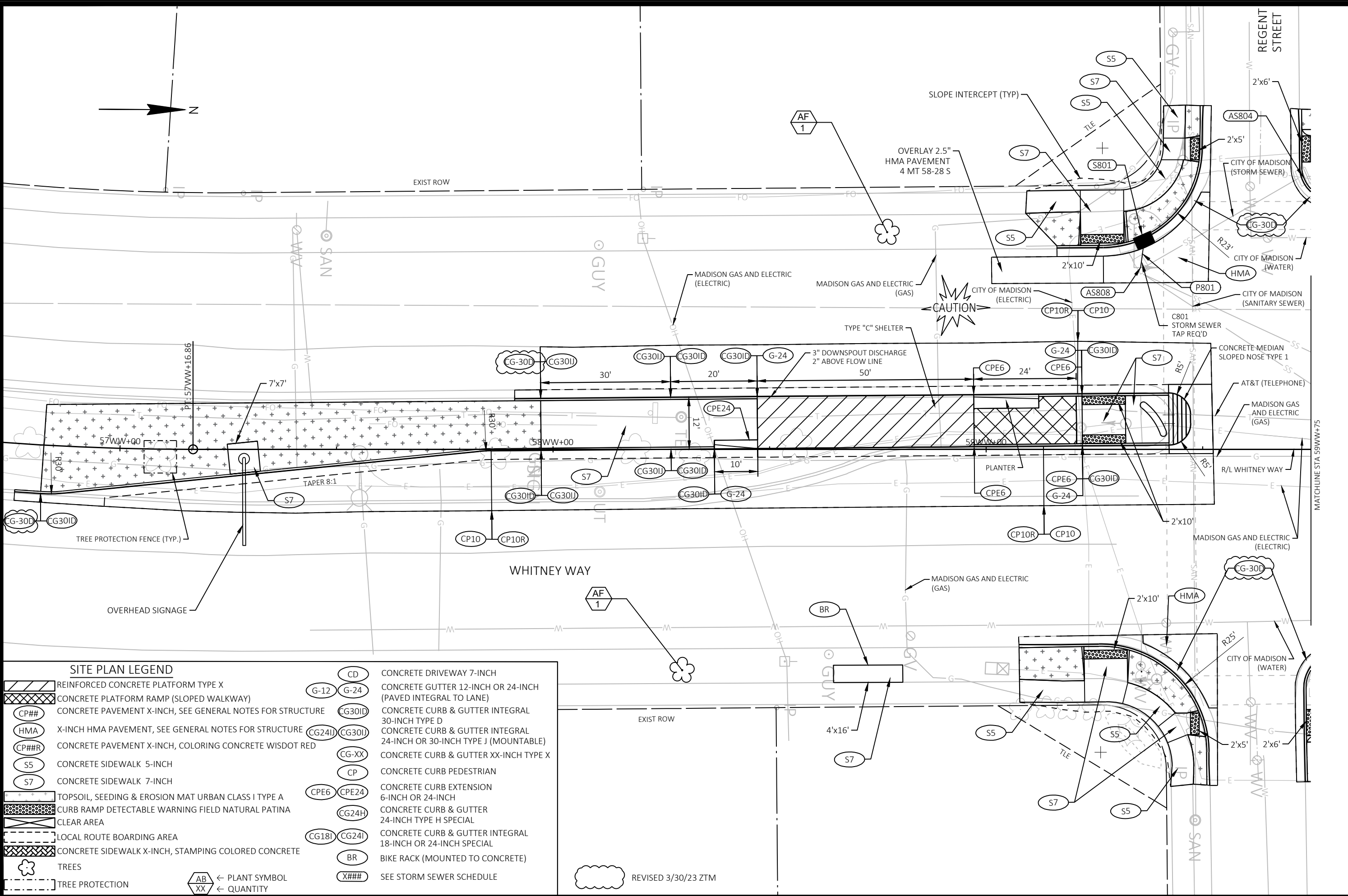

SITE PLAN LEGEND	
	REINFORCED CONCRETE PLATFORM TYPE X
	CONCRETE PLATFORM RAMP (SLOPED WALKWAY)
	CONCRETE PAVEMENT X-INCH, SEE GENERAL NOTES FOR STRUCTURE
	X-INCH HMA PAVEMENT, SEE GENERAL NOTES FOR STRUCTURE
	CONCRETE PAVEMENT X-INCH, COLORING CONCRETE WISDOT RED
	CONCRETE SIDEWALK 5-INCH
	CONCRETE SIDEWALK 7-INCH
	TOPSOIL, SEEDING & EROSION MAT URBAN CLASS I TYPE A
	CURB RAMP DETECTABLE WARNING FIELD NATURAL PATINA
	CLEAR AREA
	LOCAL ROUTE BOARDING AREA
	CONCRETE SIDEWALK X-INCH, STAMPING COLORED CONCRETE
	TREES
	TREE PROTECTION
	← PLANT SYMBOL
	← QUANTITY
	CONCRETE DRIVEWAY 7-INCH
	CONCRETE GUTTER 12-INCH OR 24-INCH (PAVED INTEGRAL TO LANE)
	CONCRETE CURB & GUTTER INTEGRAL 30-INCH TYPE D
	CONCRETE CURB & GUTTER INTEGRAL 24-INCH OR 30-INCH TYPE J (MOUNTABLE)
	CONCRETE CURB & GUTTER XX-INCH TYPE X
	CONCRETE CURB PEDESTRIAN
	CONCRETE CURB EXTENSION 6-INCH OR 24-INCH
	CONCRETE CURB & GUTTER 24-INCH TYPE H SPECIAL
	CONCRETE CURB & GUTTER INTEGRAL 18-INCH OR 24-INCH SPECIAL
	BIKE RACK (MOUNTED TO CONCRETE)
	SEE STORM SEWER SCHEDULE

REVISED 3/30/23 ZTM

PLAN REVISION 2	3/30/23	ZTM
REVISION	DATE	BY
Designed By: AECOM   Date: 2023-04-07		
60631225P		
Scale: 1 IN=20 FT		
60631225P		
CITY OF MADISON		
CONTRACT NO: 60631225C		
CITY OF MADISON, DANE COUNTY, WI		
60631225P		
SITE PLAN: WHITNEY WAY AT REGENT STREET		
BUS RAPID TRANSIT		
CITY OF MADISON		
60631225P		
P-9W		

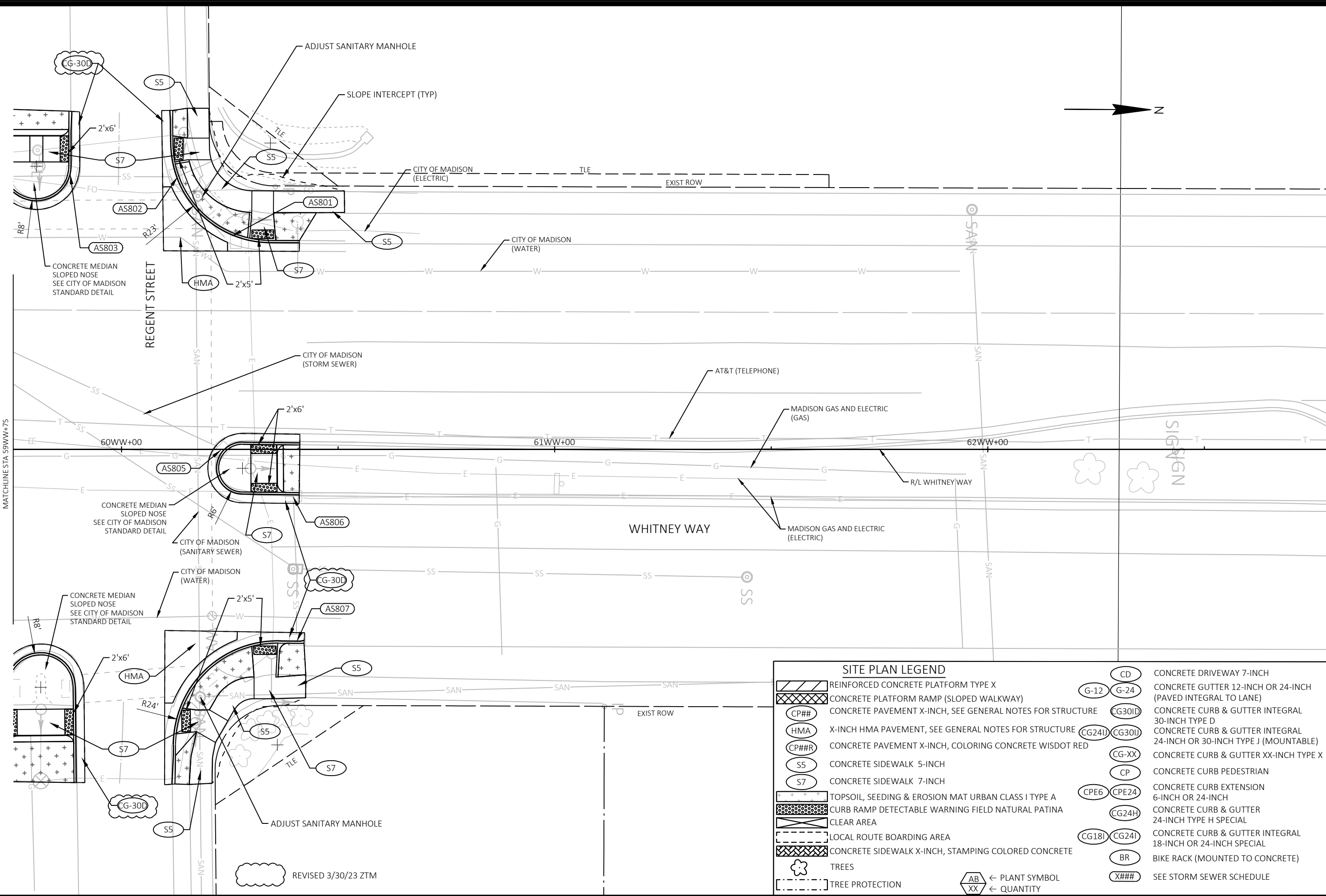

SITE PLAN LEGEND	
	REINFORCED CONCRETE PLATFORM TYPE X
	CONCRETE PLATFORM RAMP (SLOPED WALKWAY)
	CONCRETE PAVEMENT X-INCH, SEE GENERAL NOTES FOR STRUCTURE
	X-INCH HMA PAVEMENT, SEE GENERAL NOTES FOR STRUCTURE
	CONCRETE PAVEMENT X-INCH, COLORING CONCRETE WISDOT RED
	CONCRETE SIDEWALK 5-INCH
	CONCRETE SIDEWALK 7-INCH
	TOPSOIL, SEEDING & EROSION MAT URBAN CLASS I TYPE A
	CURB RAMP DETECTABLE WARNING FIELD NATURAL PATINA
	CLEAR AREA
	LOCAL ROUTE BOARDING AREA
	CONCRETE SIDEWALK X-INCH, STAMPING COLORED CONCRETE
	TREES
	TREE PROTECTION
	CONCRETE DRIVEWAY 7-INCH
	CONCRETE GUTTER 12-INCH OR 24-INCH (PAVED INTEGRAL TO LANE)
	CONCRETE CURB & GUTTER INTEGRAL 30-INCH TYPE D
	CONCRETE CURB & GUTTER INTEGRAL 24-INCH OR 30-INCH TYPE J (MOUNTABLE)
	CONCRETE CURB & GUTTER XX-INCH TYPE X
	CONCRETE CURB PEDESTRIAN
	CONCRETE CURB EXTENSION 6-INCH OR 24-INCH
	CONCRETE CURB & GUTTER 24-INCH TYPE H SPECIAL
	CONCRETE CURB & GUTTER INTEGRAL 18-INCH OR 24-INCH SPECIAL
	BIKE RACK (MOUNTED TO CONCRETE)
	SEE STORM SEWER SCHEDULE
	← PLANT SYMBOL
	← QUANTITY

REVISED 3/30/23 ZTM

MARK	PLAN REVISION 2	DATE	3/30/23	BY	ZTM
DESIGNED BY	AECOM	DATE	2023-04-07	SCALE	1 IN=20 FT
<b>SITE PLAN: WHITNEY WAY AT REGENT STREET</b> <b>BUS RAPID TRANSIT</b> <b>CITY OF MADISON</b>					
60631225P			CITY OF MADISON, DANE COUNTY, WI		
60631225C			CONTRACT NO: 60631225C		
60631225P			P-9W		

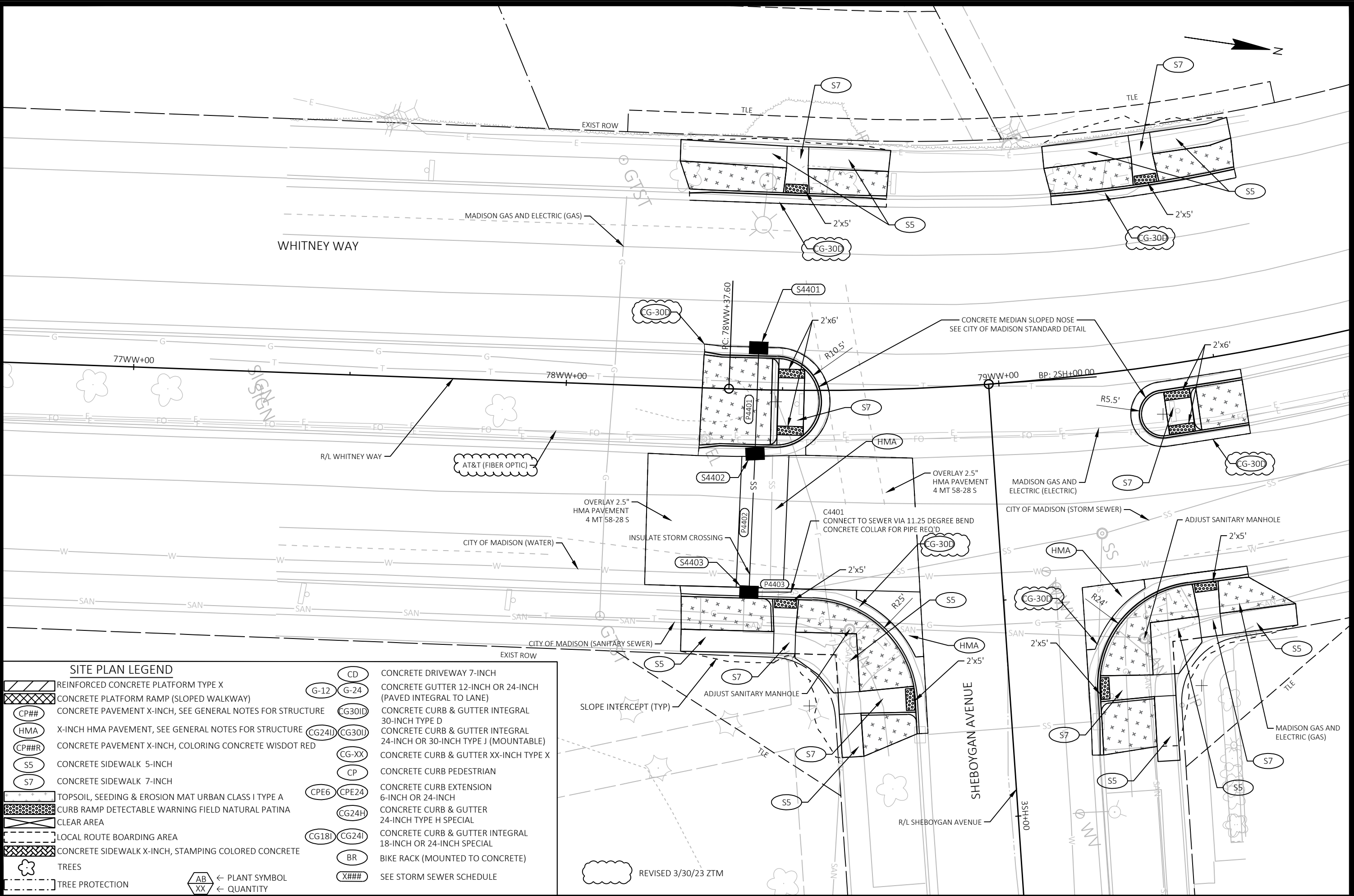

**SITE PLAN LEGEND**

	REINFORCED CONCRETE PLATFORM TYPE X		CONCRETE GUTTER 12-INCH OR 24-INCH (PAVED INTEGRAL TO LANE)
	CONCRETE PLATFORM RAMP (SLOPED WALKWAY)		CONCRETE CURB & GUTTER INTEGRAL 30-INCH TYPE D
	CONCRETE PAVEMENT X-INCH, SEE GENERAL NOTES FOR STRUCTURE		CONCRETE CURB & GUTTER INTEGRAL 24-INCH OR 30-INCH TYPE J (MOUNTABLE)
	X-INCH HMA PAVEMENT, SEE GENERAL NOTES FOR STRUCTURE		CONCRETE CURB & GUTTER XX-INCH TYPE X
	CONCRETE PAVEMENT X-INCH, COLORING CONCRETE WISDOT RED		CONCRETE CURB PEDESTRIAN
	CONCRETE SIDEWALK 5-INCH		CONCRETE CURB EXTENSION 6-INCH OR 24-INCH
	CONCRETE SIDEWALK 7-INCH		CONCRETE CURB & GUTTER 24-INCH TYPE H SPECIAL
	TOPSOIL, SEEDING & EROSION MAT URBAN CLASS I TYPE A		CONCRETE CURB & GUTTER INTEGRAL 18-INCH OR 24-INCH SPECIAL
	CURB RAMP DETECTABLE WARNING FIELD NATURAL PATINA		BIKE RACK (MOUNTED TO CONCRETE)
	CLEAR AREA		SEE STORM SEWER SCHEDULE
	LOCAL ROUTE BOARDING AREA		
	CONCRETE SIDEWALK X-INCH, STAMPING COLORED CONCRETE		
	TREES		
	TREE PROTECTION		

	CONCRETE DRIVEWAY 7-INCH
	CONCRETE GUTTER 12-INCH OR 24-INCH (PAVED INTEGRAL TO LANE)
	CONCRETE CURB & GUTTER INTEGRAL 30-INCH TYPE D
	CONCRETE CURB & GUTTER INTEGRAL 24-INCH OR 30-INCH TYPE J (MOUNTABLE)
	CONCRETE CURB & GUTTER XX-INCH TYPE X
	CONCRETE CURB PEDESTRIAN
	CONCRETE CURB EXTENSION 6-INCH OR 24-INCH
	CONCRETE CURB & GUTTER 24-INCH TYPE H SPECIAL
	CONCRETE CURB & GUTTER INTEGRAL 18-INCH OR 24-INCH SPECIAL
	BIKE RACK (MOUNTED TO CONCRETE)
	SEE STORM SEWER SCHEDULE

REVISED 3/30/23 ZTM

PLAN REVISION 2  
 DATE 3/30/23  
 BY ZTM

MARK  
 Designed By: AECOM  
 Date: 2023-04-07  
 60631225P

60631225P  
 CITY OF MADISON, DANE COUNTY, WI  
 CONTRACT NO: 60631225C

CITY OF MADISON  
 BUS RAPID TRANSIT

60631225P  
 P-10W

FILE NAME: C:\P\WORKING\AECOM\_DS20\_NA\_2019\ANDREW.TIMCO@AECOM.COM\DM586348\050212Z-PN.DWG  
 LAYOUT NAME - Plan 1 IN 20 FT  
 LAST PLOT DATE - 2023-04-07

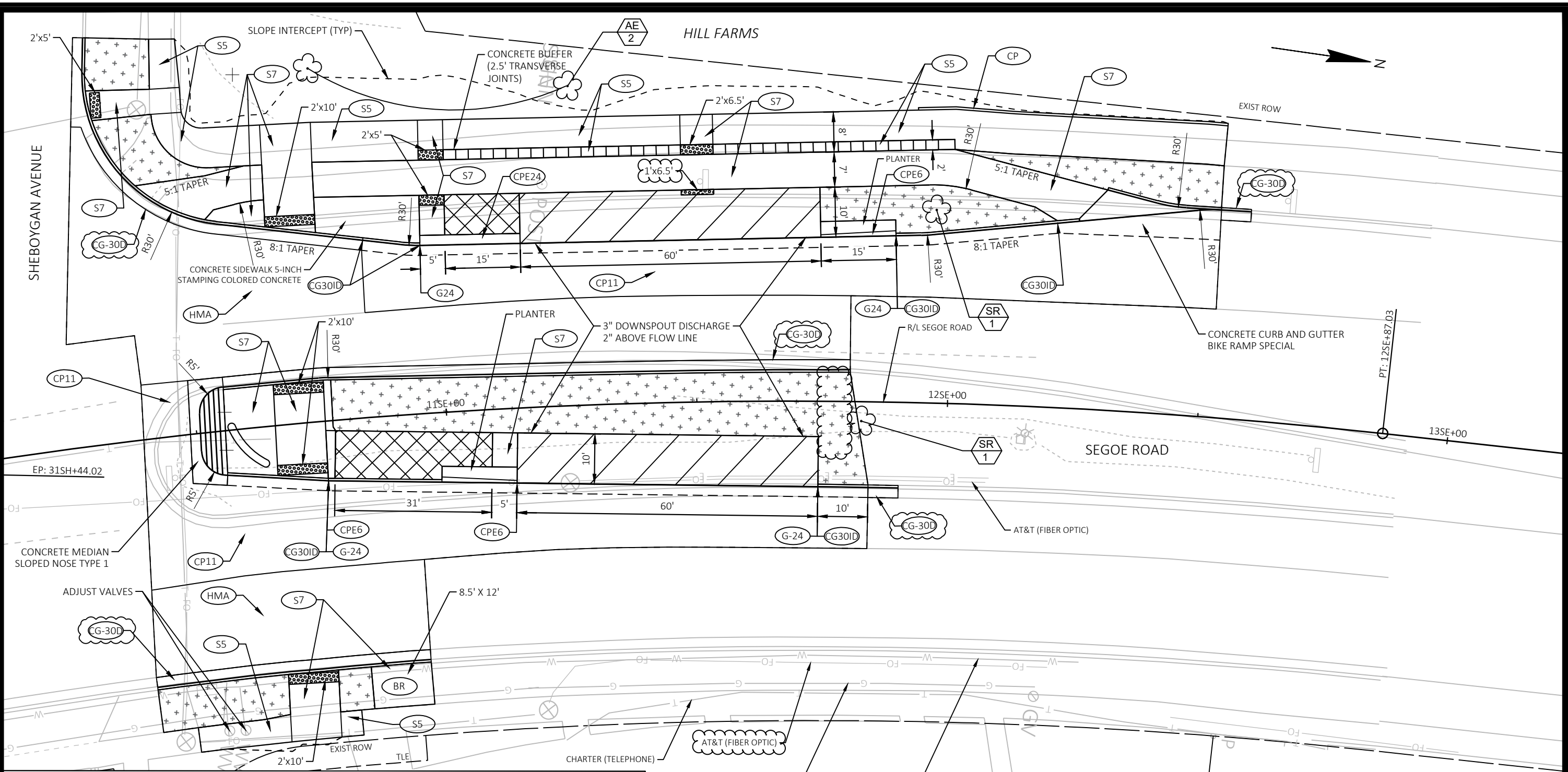

SITE PLAN LEGEND	
	REINFORCED CONCRETE PLATFORM TYPE X
	CONCRETE PLATFORM RAMP (SLOPED WALKWAY)
	CONCRETE PAVEMENT X-INCH, SEE GENERAL NOTES FOR STRUCTURE
	X-INCH HMA PAVEMENT, SEE GENERAL NOTES FOR STRUCTURE
	CONCRETE PAVEMENT X-INCH, COLORING CONCRETE WISDOT RED
	CONCRETE SIDEWALK 5-INCH
	CONCRETE SIDEWALK 7-INCH
	TOPSOIL, SEEDING & EROSION MAT URBAN CLASS I TYPE A
	CURB RAMP DETECTABLE WARNING FIELD NATURAL PATINA
	CLEAR AREA
	LOCAL ROUTE BOARDING AREA
	CONCRETE SIDEWALK X-INCH, STAMPING COLORED CONCRETE
	TREES
	TREE PROTECTION
	← PLANT SYMBOL
	← QUANTITY
	CONCRETE DRIVEWAY 7-INCH
	CONCRETE GUTTER 12-INCH OR 24-INCH (PAVED INTEGRAL TO LANE)
	CONCRETE CURB & GUTTER INTEGRAL 30-INCH TYPE D
	CONCRETE CURB & GUTTER INTEGRAL 24-INCH OR 30-INCH TYPE J (MOUNTABLE)
	CONCRETE CURB & GUTTER XX-INCH TYPE X
	CONCRETE CURB PEDESTRIAN
	CONCRETE CURB EXTENSION 6-INCH OR 24-INCH
	CONCRETE CURB & GUTTER 24-INCH TYPE H SPECIAL
	CONCRETE CURB & GUTTER INTEGRAL 18-INCH OR 24-INCH SPECIAL
	BIKE RACK (MOUNTED TO CONCRETE)
	SEE STORM SEWER SCHEDULE

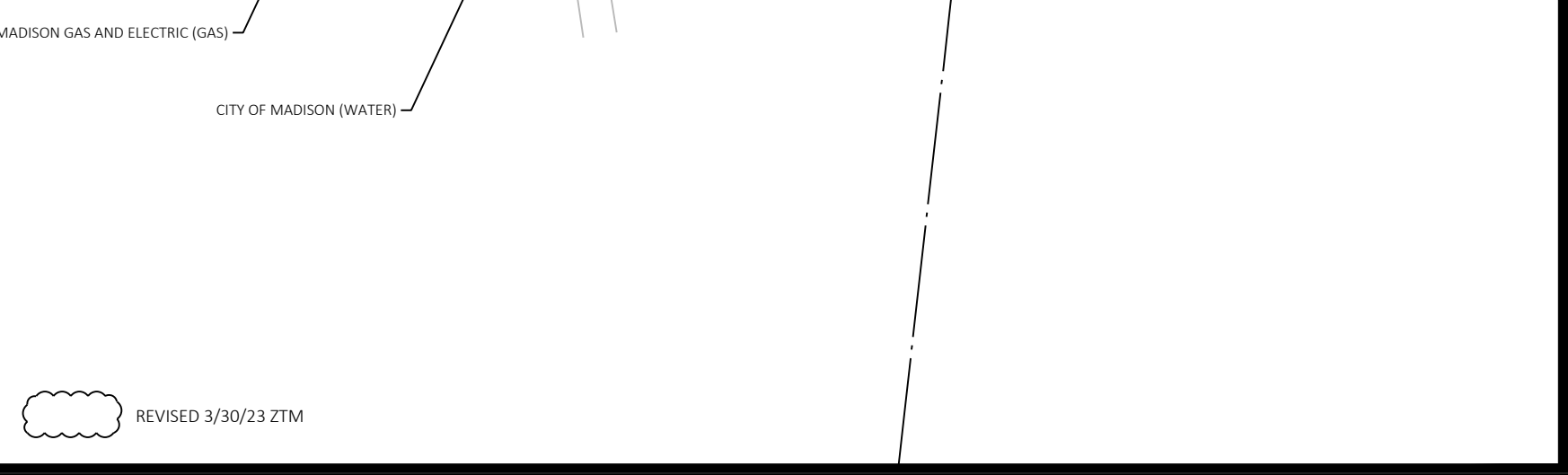

60631225P  
 CITY OF MADISON, DANE COUNTY, WI  
 BUS RAPID TRANSIT  
**CITY OF MADISON**  
 60631225P  
 P-12W

SITE PLAN: SHEBOYGAN AVENUE AT SEGOE ROAD  
 PLAN REVISION 2  
 REVISION DATE: 2023-04-07  
 DESIGNED BY: AECOM  
 DATE: 2023-04-07  
 SCALE: 1 IN=20 FT

3/30/23 ZTM  
 DATE BY

FILE NAME: C:\P\WORKING\AECOM\_DS20\_NA\_2019\ANDREW.TIMCO@AECOM.COM\DM586348\0502158-PN.DWG  
 LAYOUT NAME - Plan 1 IN 20 FT 01  
 LAST PLOT DATE - 2023-04-07

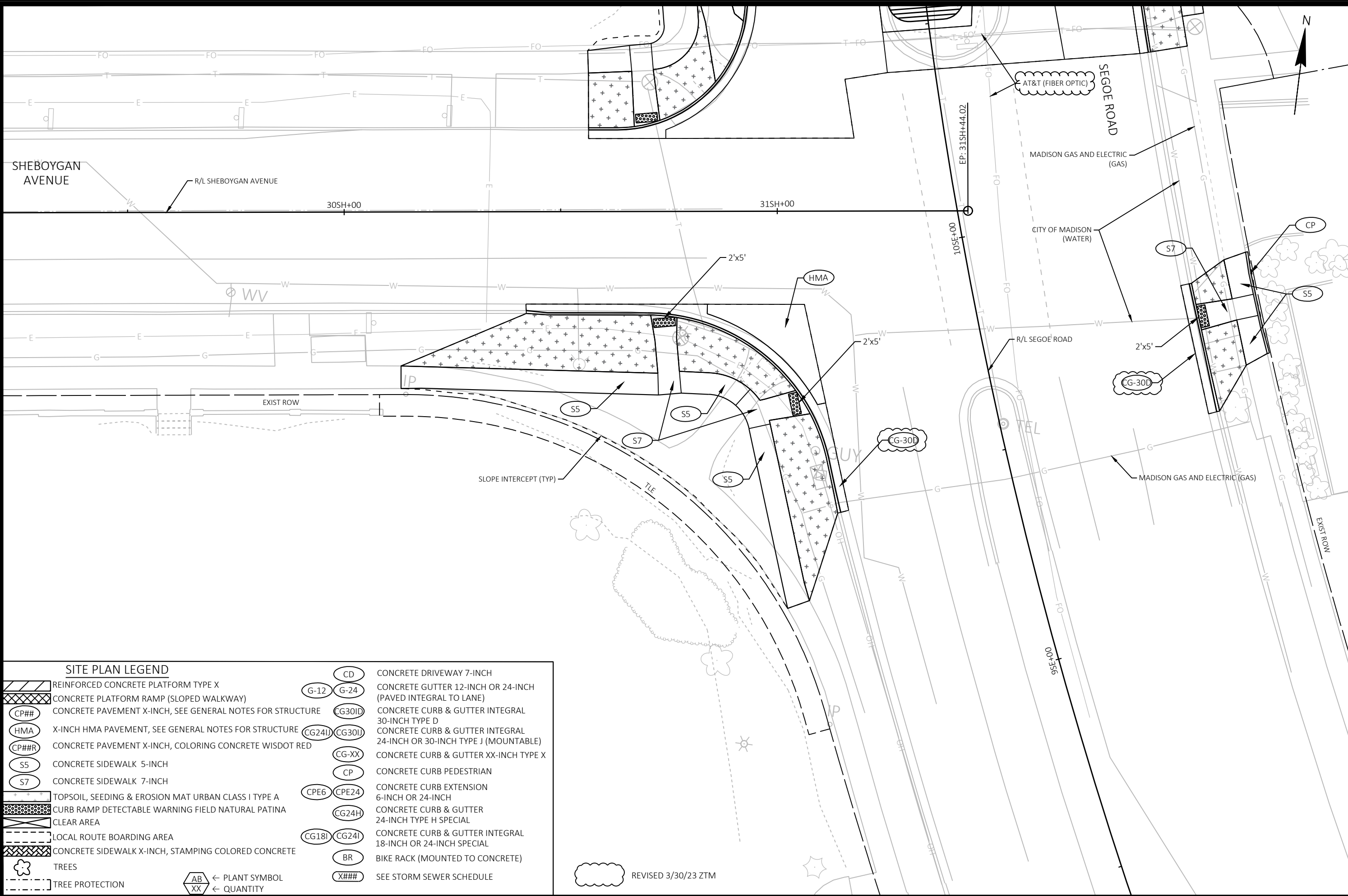

**SITE PLAN LEGEND**

	REINFORCED CONCRETE PLATFORM TYPE X		CD CONCRETE DRIVEWAY 7-INCH
	CONCRETE PLATFORM RAMP (SLOPED WALKWAY)		G-12 G-24 CONCRETE GUTTER 12-INCH OR 24-INCH (PAVED INTEGRAL TO LANE)
	CONCRETE PAVEMENT X-INCH, SEE GENERAL NOTES FOR STRUCTURE		CG30ID CONCRETE CURB & GUTTER INTEGRAL 30-INCH TYPE D
	X-INCH HMA PAVEMENT, SEE GENERAL NOTES FOR STRUCTURE		CG24H CG30H CONCRETE CURB & GUTTER INTEGRAL 24-INCH OR 30-INCH TYPE J (MOUNTABLE)
	CONCRETE PAVEMENT X-INCH, COLORING CONCRETE WISDOT RED		CG-XX CONCRETE CURB & GUTTER XX-INCH TYPE X
	S5 CONCRETE SIDEWALK 5-INCH		CP CONCRETE CURB PEDESTRIAN
	S7 CONCRETE SIDEWALK 7-INCH		CPE6 CPE24 CONCRETE CURB EXTENSION 6-INCH OR 24-INCH
	TOPSOIL, SEEDING & EROSION MAT URBAN CLASS I TYPE A		CG24H CONCRETE CURB & GUTTER 24-INCH TYPE H SPECIAL
	CURB RAMP DETECTABLE WARNING FIELD NATURAL PATINA		CG18H CG24H CONCRETE CURB & GUTTER INTEGRAL 18-INCH OR 24-INCH SPECIAL
	CLEAR AREA		BR BIKE RACK (MOUNTED TO CONCRETE)
	LOCAL ROUTE BOARDING AREA		X### SEE STORM SEWER SCHEDULE
	CONCRETE SIDEWALK X-INCH, STAMPING COLORED CONCRETE		
	TREES		
	TREE PROTECTION		
	AB XX ← PLANT SYMBOL		
	XX ← QUANTITY		

REVISED 3/30/23 ZTM

MARK	DESIGNED BY: AECOM	DATE: 2023-04-07	SCALE: 1 IN=20 FT
PLAN REVISION 2	REVISION	DATE	BY
3/30/23	ZTM		

**60631225P**  
 CITY OF MADISON, DANE COUNTY, WI  
**CONTRACT NO: 60631225C**

---

**SITE PLAN: SHEBOYGAN AVENUE AT SEGOE ROAD**  
**BUS RAPID TRANSIT**  
**CITY OF MADISON**

---

**60631225P**  
**P-12W**





Test Platform at Metro Satellite Facility

POINT NUMBER	Y COORDS	X COORDS	ELEVATION	COMMENT
HRTPO1	510721.17	839218.45	879.75	MATCH
HRTPO2	510671.17	839217.98	878.52	MATCH
HRTPO3	510672.15	839108.48	878.42	MATCH
HRTPO4	510722.15	839108.95	879.81	MATCH
HRTPO5	510706.15	839108.80	879.42	MATCH
HRTPO6	510706.11	839113.80	879.44	EL
HRTPO7	510706.06	839118.80	879.47	FL
HRTPO8	510705.93	839133.80	880.67	TOP
HRTPO9	510705.39	839193.80	880.97	TOP
HRTPO10	510693.39	839193.69	880.79	TOP
HRTPO11	510693.93	839133.69	880.49	TOP
HRTPO12	510694.06	839118.69	879.29	FL
HRTPO13	510694.11	839113.69	879.16	EL
HRTPO14	510694.15	839108.69	879.08	MATCH
HRTPO15	510705.26	839208.80	879.77	FL
HRTPO16	510693.26	839208.69	879.59	FL
HRTPO17	510720.95	839243.45	879.64	MATCH
HRTPO18	510765.74	839243.87	880.26	MATCH
HRTPO19	510766.77	839134.37	880.66	MATCH
HRTPO20	510721.93	839133.95	879.85	MATCH

REVISED 4/05/2023 MEM

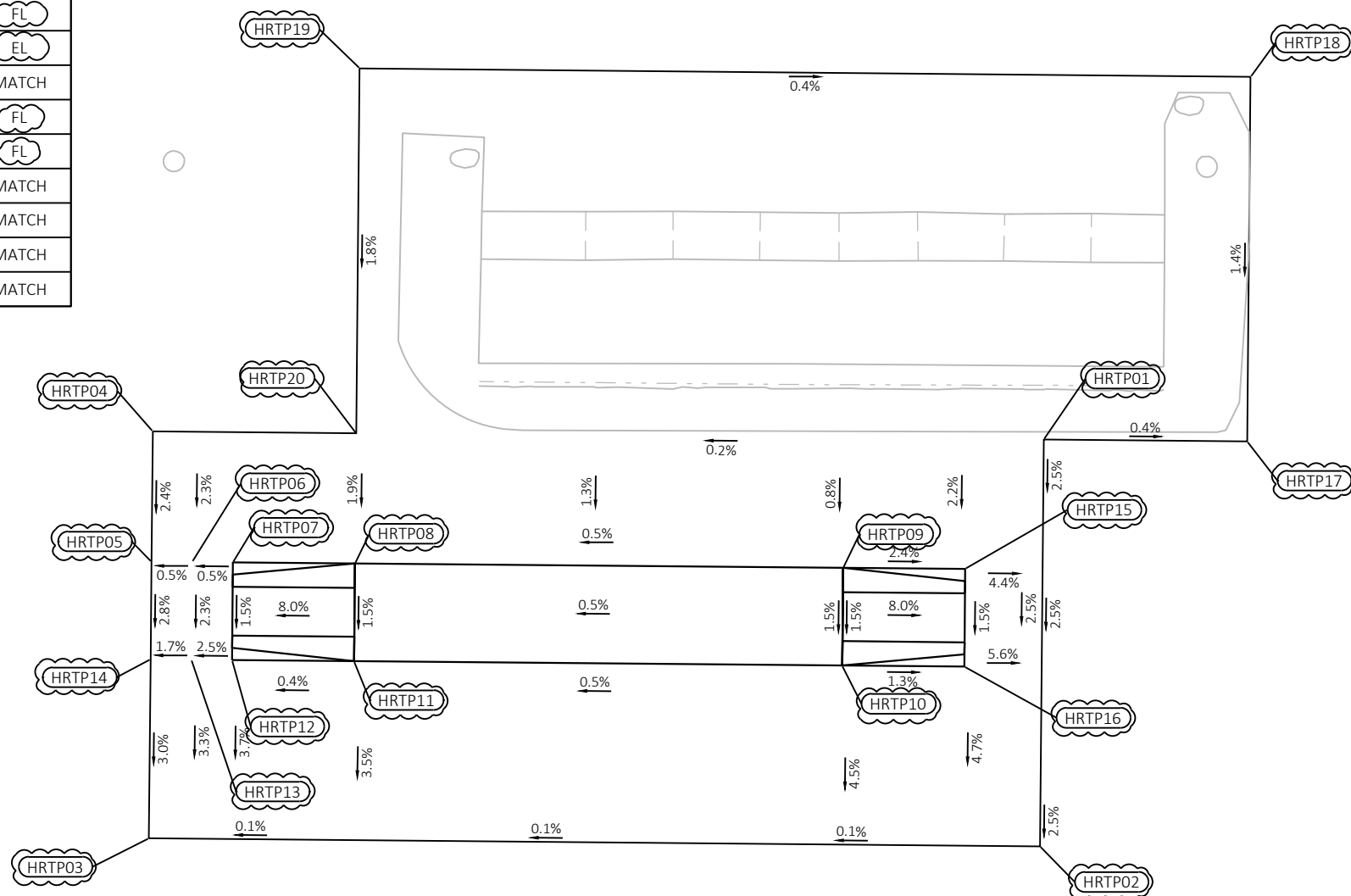

MARK	DESIGNED BY	DATE	BY	Scale: 1"=20 FT
	AECOM	2023-04-06		
	PLAN REVISION 2	04/05/23	MEM	
	PLAN REVISION 1	03/01/23	MEM	

60631225P  
**SITE PLAN: METRO SATELLITE MAINTENANCE FACILITY**  
**BUS RAPID TRANSIT**  
**CITY OF MADISON**  
 CITY OF MADISON, DANE COUNTY, WI  
 CONTRACT NO: 60631225C



60631225P  
**G35-E**

FILE NAME: C:\PWORKING\AECOM\_DS20\_NA\_2019\MEGHAN.MCCARTHY@AECOM.COM\DM586348\050303C-GD.DWG  
 LAYOUT NAME - Plan 1 IN 20 FT  
 LAST PLOT DATE - 2023-04-06

WHITNEY WAY AT REGENT STREET

SCC Code	ITEM NUMBER	DESCRIPTION	UNITS	QUANTITY
40.01	201.0105	Clearing	STA	2.00
40.01	201.0120	Clearing	ID	37.00
40.01	201.0205	Grubbing	STA	2.00
40.01	201.0220	Grubbing	ID	37.00
40.01	204.0150	Removing Curb & Gutter	LF	860.00
40.01	204.0155	Removing Concrete Sidewalk	SY	150.00
40.02	204.0220	Removing Inlets	EACH	1.00
40.01	205.0100	Excavation Common	CY	430.00
10.02	305.0120	Base Aggregate Dense 1 1/4-Inch	TON	100.00
20.01	305.0120	Base Aggregate Dense 1 1/4-Inch	TON	22.00
40.06	305.0120	Base Aggregate Dense 1 1/4-Inch	TON	24.00
40.07	305.0120	Base Aggregate Dense 1 1/4-Inch	TON	220.00
10.02	305.0130	Base Aggregate Dense 3-Inch	TON	110.00
20.01	305.0130	Base Aggregate Dense 3-Inch	TON	24.00
40.07	305.0130	Base Aggregate Dense 3-Inch	TON	210.00
10.02	405.0100	Coloring Concrete WisDOT Red	CY	85.00
10.02	415.0100	Concrete Pavement 10-Inch	SY	306.00
40.07	415.0100	Concrete Pavement 10-Inch	SY	159.00
40.07	415.4100	Concrete Pavement Joint Filling	SY	675.00
40.06	455.0605	Tack Coat	GAL	13.00
40.06	460.2000	Incentive Density HMA Pavement	DOL	20.00
40.06	460.5224	HMA Pavement 4 LT 58-28 S	TON	21.00
40.06	460.6224	HMA Pavement 4 MT 58-28 S	TON	3.00
40.02	520.8000	Concrete Collars for Pipe	EACH	1.00
10.02	601.0205	Concrete Gutter 24-Inch	LF	160.00
40.07	601.0411	Concrete Curb & Gutter 30-Inch Type D	LF	570.00
40.07	601.0454	Concrete Curb & Gutter Integral 30-Inch Type J	LF	60.00
40.06	602.0410	Concrete Sidewalk 5-Inch	SF	1960.00
40.06	602.0420	Concrete Sidewalk 7-Inch	SF	820.00
40.06	602.0515	Curb Ramp Detectable Warning Field Natural Patina	SF	210.00
40.02	611.3230	Inlets 2x3-FT	EACH	1.00
40.02	611.8110	Adjusting Manhole Covers	EACH	1.00
40.02	611.8115	Adjusting Inlet Covers	EACH	8.00
40.02	611.9710	Salvaged Inlet Covers	EACH	1.00
40.07	620.0300	Concrete Median Sloped Nose	SF	498.00
10.02	624.0100	Water	MGAL	4.30
40.07	624.0100	Water	MGAL	10.20
40.06	625.0100	Topsoil	SY	300.00
40.06	628.2006	Erosion Mat Urban Class I Type A	SY	300.00
40.06	628.6505	Soil Stabilizer Type A	ACRE	0.06
40.02	628.7020	Inlet Protection Type D	EACH	15.00
40.06	629.0210	Fertilizer Type B	CWT	0.17
40.06	630.0500	Seed Water	MGAL	6.70
40.02	650.4000	Construction Staking Storm Sewer	EACH	9.00
40.07	650.5000	Construction Staking Base	LF	50.00
40.07	650.5500	Construction Staking Curb Gutter and Curb & Gutter	LF	290.00

PLAN REVISION 2	3/30/23	ALM
ADDENDUM 4	11/29/22	ALM
REVISION	DATE	BY
Mark		
Designed By: AECOM	Date:	Scale: NTS
60631225P	3/30/2023	

60631225P  
 MISCELLANEOUS QUANTITIES  
 CITY OF MADISON, DANE COUNTY, WI  
 BUS RAPID TRANSIT  
 CITY OF MADISON  
 CONTRACT NO: 60631225C



60631225P

MQ-16

C:\OneDrive\AECOM\Cy of Madison BRT Quantities - Cost Quantities\Madison BRT MQ Plan Sheets.pptx  
 LAST PLOT DATE: 3/30/2023  
 FILE NAME:

SHEBOYGAN & WHITNEY WAY ROADWAY IMPROVEMENTS

SCC Code	ITEM NUMBER	DESCRIPTION	UNITS	QUANTITY
40.01	204.0115	Removing Asphaltic Surface Butt Joints	SY	14.00
40.01	204.0120	Removing Asphaltic Surface Milling	SY	180.00
40.01	204.0150	Removing Curb & Gutter	LF	370.00
40.01	204.0155	Removing Concrete Sidewalk	SY	170.00
40.02	204.0220	Removing Inlets	EACH	3.00
40.02	204.0245.01	Removing Storm Sewer - 12 inch or less	LF	57.00
40.01	205.0100	Excavation Common	CY	120.00
40.06	305.0120	Base Aggregate Dense 1 1/4-Inch	TON	10.00
40.07	305.0120	Base Aggregate Dense 1 1/4-Inch	TON	95.00
40.07	305.0130	Base Aggregate Dense 3-Inch	TON	78.00
40.06	415.4100	Concrete Pavement Joint Filling	SY	98.00
40.06	455.0605	Tack Coat	GAL	33.00
40.06	460.2000	Incentive Density HMA Pavement	DOL	28.00
40.07	460.6224	HMA Pavement 4 MT 58-28 S	TON	44.00
40.02	520.8000	Concrete Collars for Pipe	EACH	1.00
40.07	601.0411	Concrete Curb & Gutter 30-Inch Type D	LF	350.00
40.06	602.0410	Concrete Sidewalk 5-Inch	SF	780.00
40.06	602.0420	Concrete Sidewalk 7-Inch	SF	640.00
40.06	602.0515	Curb Ramp Detectable Warning Field Natural Patina	SF	108.00
40.02	608.0312	Storm Sewer Pipe Reinforced Concrete Class III 12-Inch	LF	66.00
40.02	611.3230	Inlets 2x3-FT	EACH	3.00
40.02	611.9710	Salvaged Inlet Covers	EACH	3.00
40.07	620.0300	Concrete Median Sloped Nose	SF	84.00
40.07	624.0100	Water	MGAL	3.70
40.06	625.0100	Topsoil	SY	210.00
40.06	628.2006	Erosion Mat Urban Class I Type A	SY	210.00
40.06	628.6505	Soil Stabilizer Type A	ACRE	0.04
40.06	629.0210	Fertilizer Type B	CWT	0.12
40.06	630.0500	Seed Water	MGAL	4.70
40.02	650.4000	Construction Staking Storm Sewer	EACH	3.00
40.07	650.5000	Construction Staking Base	LF	61.00
40.07	650.5500	Construction Staking Curb Gutter and Curb & Gutter	LF	350.00
40.06	650.9000	Construction Staking Curb Ramps	EACH	8.00
40.01	690.0150	Sawing Asphalt	LF	160.00
40.01	690.0250	Sawing Concrete	LF	330.00
40.02	SPV.0060.619	Adjust Manhole Cover Special	EACH	2.00
40.02	SPV.0060.631	Furnish & Install Insulation	EACH	1.00
40.06	SPV.0085.501	Seeding	LB	3.80

PLAN REVISION 2	3/30/23	ALM
ADDENDUM 4	11/29/22	ALM
REVISION	DATE	BY
Mark	Date	Scale: NTS
Designed By: AECOM	3/30/2023	
60631225P		

60631225P  
 CITY OF MADISON, DANE COUNTY, WI  
 CONTRACT NO: 60631225C  
 MISCELLANEOUS QUANTITIES  
 BUS RAPID TRANSIT  
 CITY OF MADISON



60631225P

MQ-18

C:\OneDrive\AECOM\Cy of Madison BRT Quantities - Cost Quantities\Madison BRT MQ Plan Sheets.pptx  
 LAST PLOT DATE: 3/30/2023

SHEBOYGAN AVENUE AT SEGOE ROAD WB

SCC Code	ITEM NUMBER	DESCRIPTION	UNITS	QUANTITY
40.01	204.0150	Removing Curb & Gutter	LF	440.00
40.01	204.0155	Removing Concrete Sidewalk	SY	240.00
40.01	205.0100	Excavation Common	CY	800.00
10.03	305.0120	Base Aggregate Dense 1 1/4-Inch	TON	69.00
20.01	305.0120	Base Aggregate Dense 1 1/4-Inch	TON	30.00
40.07	305.0120	Base Aggregate Dense 1 1/4-Inch	TON	290.00
10.03	305.0130	Base Aggregate Dense 3-Inch	TON	76.00
20.01	305.0130	Base Aggregate Dense 3-Inch	TON	30.00
40.07	305.0130	Base Aggregate Dense 3-Inch	TON	197.00
10.03	415.0110	Concrete Pavement 11-Inch	SY	210.00
10.03	415.4100	Concrete Pavement Joint Filling	SY	331.00
40.07	455.0605	Tack Coat	GAL	50.00
40.07	460.2000	Incentive Density HMA Pavement	DOL	70.00
40.07	460.6224	HMA Pavement 4 MT 58-28 S	TON	110.00
10.03	601.0205	Concrete Gutter 24-Inch	LF	95.00
40.07	601.0411	Concrete Curb & Gutter 30-Inch Type D	LF	376.00
40.06	601.0600	Concrete Curb Pedestrian	LF	62.00
40.06	602.0410	Concrete Sidewalk 5-Inch	SF	2360.00
40.06	602.0420	Concrete Sidewalk 7-Inch	SF	1700.00
40.06	602.0515	Curb Ramp Detectable Warning Field Natural Patina	SF	83.00
10.03	624.0100	Water	MGAL	2.90
40.07	624.0100	Water	MGAL	11.00
40.06	625.0100	Topsoil	SY	230.00
40.06	628.2006	Erosion Mat Urban Class I Type A	SY	230.00
40.06	628.6505	Soil Stabilizer Type A	ACRE	0.05
40.06	629.0210	Fertilizer Type B	CWT	0.13
40.06	630.0500	Seed Water	MGAL	5.20
40.07	650.5000	Construction Staking Base	LF	157.00
40.07	650.5500	Construction Staking Curb Gutter and Curb & Gutter	LF	300.00
40.07	650.7000	Construction Staking Concrete Pavement	LF	170.00
40.06	650.9000	Construction Staking Curb Ramps	EACH	7.00
20.01	652.0235	Conduit Rigid Nonmetallic Schedule 40 3-Inch	LF	133.00
20.01	652.0615	Conduit Special 3-Inch	LF	36.00
40.01	690.0150	Sawing Asphalt	LF	420.00
40.01	690.0250	Sawing Concrete	LF	93.00
40.07	715.0720	Incentive Compressive Strength Concrete Pavement	DOL	60.00
20.01	SPV.0060.201	Install Electrical Pull Box Type I	EACH	2.00
20.01	SPV.0060.301	Platform Electrical Cabinet	EACH	1.00
20.01	SPV.0060.302	Platform Communication Cabinet	EACH	1.00
20.01	SPV.0060.303	Snow Melt System Shelter Type A1	EACH	1.00
20.01	SPV.0060.316	Shelter Photovoltaic System	EACH	1.00
20.01	SPV.0060.401	Reinforced Concrete Platform Type A1	EACH	1.00
20.01	SPV.0060.417	Platform Shelter Type A1	EACH	1.00
40.06	SPV.0060.504.01	Trees (Early Glow Buckeye, B&B, 2-IN)	EACH	2.00
40.06	SPV.0060.504.18	Trees (Japanese Tree Lilac, B&B, 2-IN)	EACH	1.00
40.06	SPV.0060.507.01	Perennials & Native Grasses (Butterfly Milkweed, Potted, 1 GAL)	EACH	3.00

3/30/23	ALM	BY
11/29/22	ALM	DATE
REVISION	REVISION	Scale: NTS
ADDENDUM 4	ADDENDUM 4	Date: 3/30/2023
PLAN REVISION 2	PLAN REVISION 2	Designed By: AECOM
60631225P	60631225P	Mark

60631225P  
 MISCELLANEOUS QUANTITIES  
 CITY OF MADISON, DANE COUNTY, WI  
 BUS RAPID TRANSIT  
 CITY OF MADISON  
 CONTRACT NO: 60631225C



60631225P

MQ-21

C:\OneDrive\AECOM\Cy of Madison BRT Quantities - Cost Quantities\Madison BRT MQ Plan Sheets.pptx  
 LAST PLOT DATE: 3/30/2023  
 FILE NAME:

SHEBOYGAN AVENUE AT SEGOE ROAD EB

SCC Code	ITEM NUMBER	DESCRIPTION	UNITS	QUANTITY
40.01	204.0150	Removing Curb & Gutter	LF	390.00
40.01	204.0155	Removing Concrete Sidewalk	SY	45.00
40.01	205.0100	Excavation Common	CY	190.00
10.02	305.0120	Base Aggregate Dense 1 1/4-Inch	TON	80.00
20.01	305.0120	Base Aggregate Dense 1 1/4-Inch	TON	30.00
40.06	305.0120	Base Aggregate Dense 1 1/4-Inch	TON	3.00
40.07	305.0120	Base Aggregate Dense 1 1/4-Inch	TON	90.00
10.02	305.0130	Base Aggregate Dense 3-Inch	TON	90.00
20.01	305.0130	Base Aggregate Dense 3-Inch	TON	30.00
40.07	305.0130	Base Aggregate Dense 3-Inch	TON	80.00
10.02	415.0110	Concrete Pavement 11-Inch	SY	230.00
10.02	415.4100	Concrete Pavement Joint Filling	SY	288.00
40.06	455.0605	Tack Coat	GAL	15.00
40.06	460.2000	Incentive Density HMA Pavement	DOL	21.00
40.06	460.6224	HMA Pavement 4 MT 58-28 S	TON	30.00
10.02	601.0205	Concrete Gutter 24-Inch	LF	98.00
40.07	601.0411	Concrete Curb & Gutter 30-Inch Type D	LF	121.00
40.06	601.0600	Concrete Curb Pedestrian	LF	24.00
40.06	602.0410	Concrete Sidewalk 5-Inch	SF	280.00
40.06	602.0420	Concrete Sidewalk 7-Inch	SF	660.00
40.07	602.0515	Curb Ramp Detectable Warning Field Natural Patina	SF	70.00
40.07	620.0300	Concrete Median Sloped Nose	SF	147.00
10.02	624.0100	Water	MGAL	3.30
40.07	624.0100	Water	MGAL	4.50
40.06	625.0100	Topsoil	SY	200.00
40.06	628.2006	Erosion Mat Urban Class I Type A	SY	200.00
40.06	628.6505	Soil Stabilizer Type A	ACRE	0.04
40.06	629.0210	Fertilizer Type B	CWT	0.11
40.06	630.0500	Seed Water	MGAL	4.50
40.07	650.5000	Construction Staking Base	LF	55.00
40.07	650.5500	Construction Staking Curb Gutter and Curb & Gutter	LF	91.00
40.07	650.7000	Construction Staking Concrete Pavement	LF	143.00
40.06	650.9000	Construction Staking Curb Ramps	EACH	3.00
40.01	690.0150	Sawing Asphalt	LF	220.00
40.01	690.0250	Sawing Concrete	LF	75.00
40.07	715.0720	Incentive Compressive Strength Concrete Pavement	DOL	70.00
40.07	SPV.0060.003	Bike Rack	EACH	1.00
20.01	SPV.0060.301	Platform Electrical Cabinet	EACH	1.00
20.01	SPV.0060.302	Platform Communication Cabinet	EACH	1.00
20.01	SPV.0060.309	Snow Melt System Shelter Type A7	EACH	1.00
20.01	SPV.0060.316	Shelter Photovoltaic System	EACH	1.00

PLAN REVISION 2	3/30/23	ALM
ADDENDUM 4	11/29/22	ALM
REVISION	DATE	BY
Mark	Date	Scale: NTS
Designed By: AECOM	3/30/2023	
60631225P		

60631225P  
 MISCELLANEOUS QUANTITIES  
 CITY OF MADISON, DANE COUNTY, WI  
 BUS RAPID TRANSIT  
 CITY OF MADISON  
 CONTRACT NO: 60631225C



60631225P

MQ-23

C:\OneDrive\AECOM\City of Madison BRT Quantities - Cost Quantities\Madison BRT MQ Plan Sheets.pptx  
 LAST PLOT DATE: 3/30/2023  
 FILE NAME: